

SITE LOCATION

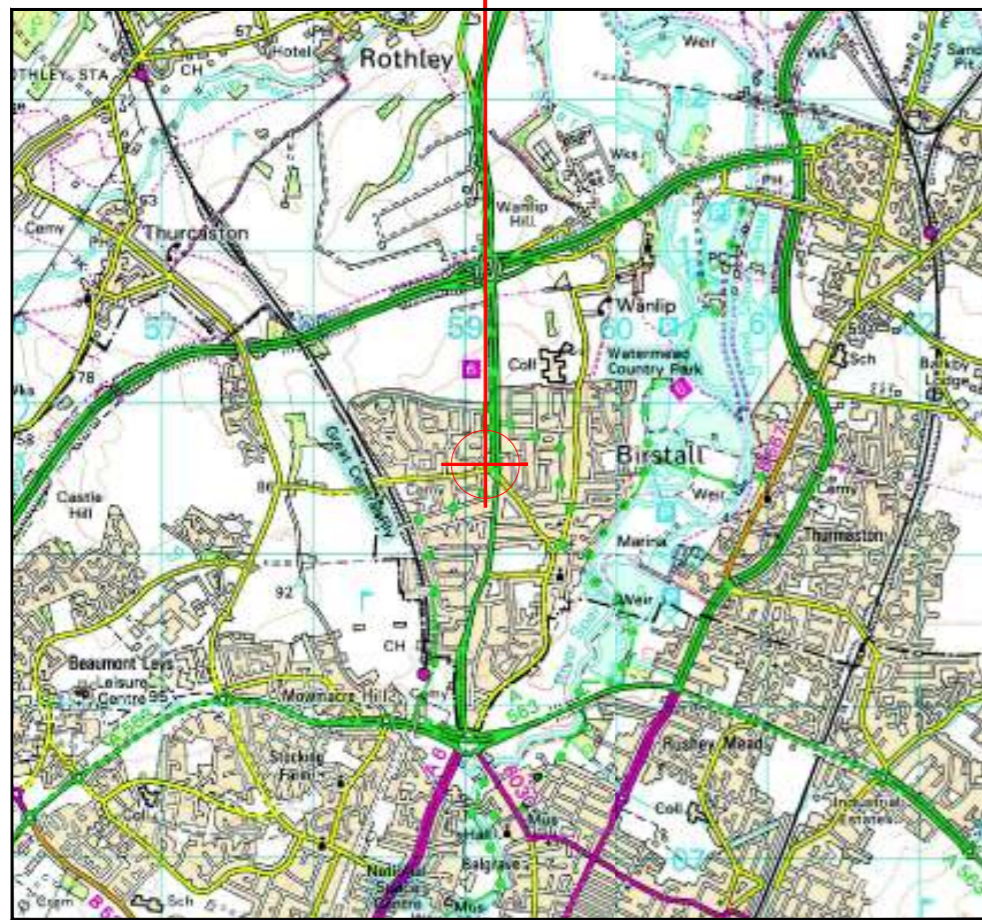

Reproduced by permission of Ordnance Survey on behalf of the Controller of Her Majesty's Stationery Office
All rights reserved. © Crown Copyright licence no. 100022432



SITE LOCATION

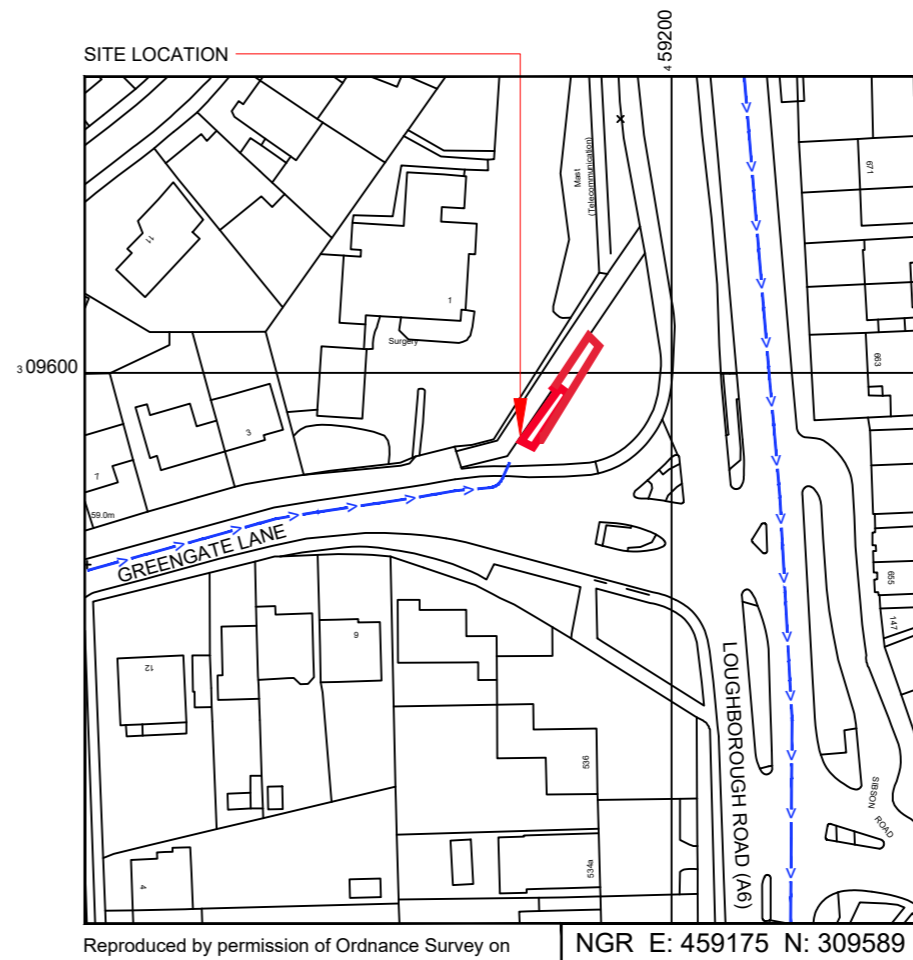

Reproduced by permission of Ordnance Survey on behalf of the Controller of Her Majesty's Stationery Office
All rights reserved. © Crown Copyright licence no. 100022432

NGR E: 459175 N: 309589

SITE LOCATION PLAN

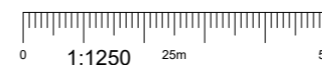

SITE AREA PLAN

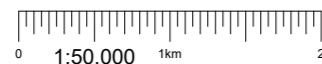

SITE PHOTOGRAPH



GOOGLE MAPS QR CODE

GOOGLE MAPS - <https://goo.gl/maps/tBJqA9hJZTUzLLYq6>
GOOGLE STREET VIEW - <https://goo.gl/maps/Yqxa3m4xxhvgEHSq6>

NOTES:

1. ALL DIMENSIONS IN MM UNLESS OTHERWISE NOTED.

DIRECTIONS TO SITE:

EXIT THE M1 NORTHBOUND AT JUNCTION 21a AND CONTINUE ONTO LEICESTER WESTERN BYPASS (A46) AND THEN FOLLOW FOR 5.3 MILES BEFORE EXITING ONTO THE A6/WANLIP SLIP ROAD TOWARDS LEICESTER. AT THE ROUNDABOUT TAKE THE 3RD EXIT ONTO LOUGHBOROUGH ROAD (A6) AND FOLLOW FOR 1.0 MILE BEFORE TURNING RIGHT ONTO ELMFIELD AVENUE. FOLLOW FOR APPROX. 300FT AND THEN TURN RIGHT ONTO POPLAR AVENUE. THEN TURN RIGHT ONTO GREENGATE LANE. SITE LOCATION IS ON LEFT HAND SIDE AFTER THE ENTRANCE TO GREENGATE MEDICAL CENTRE.

Site Provider's Property Boundary:



Access Route To Site:



Access Route:



Master: M001	MBNL / EE / H3G	Project: H3G UNILATERAL SW	Purpose of Issue: Planning	Issue: B
Date: 28/04/2020	Drawn: TH	Revision / Upgrade Description: Column & Cabinet specification and layout amended		
Checked: JTP	Approved: K.Winland			
Master: M001	MBNL / EE / H3G	Project: H3G UNILATERAL SW	Purpose of Issue: Planning	Issue: A
Date: 30/03/2020	Drawn: DJF	Revision / Upgrade Description: First Issue		
Checked: JTP	Approved: K.Winland			



Hutchison 3G UK Limited
Star House, 20 Grenfell Road
Madderhead, SL0 1EH
Tel: 01628 765 000
Fax: 01628 765 001



Hatfield Business Park
Hatfield
Hertfordshire
AL10 9BW
Tel: 01707 315000
Fax: 01707 319001



Mobile Broadband Network Limited
Sixth Floor, Thames Tower, Station Road, Reading, RG1 1LX

Design Consultant & Principal Contractor:

Mono Consultants Limited
Culzean House,
36 Renfield Street, Glasgow,
G2 1LU



t. 44 (0) 141 566 6660
f. 44 (0) 141 566 6661
www.monoconsultants.com

Site Name: GREENGATE LANE DNS

Site ID: 981717

Address: GREENGATE LANE
BIRSTALL, LEICESTER,
LEICESTERSHIRE,
LE4 3JF

Title: 002 SITE LOCATION PLAN

Project: H3G UNILATERAL SW

Purpose of Issue: PLANNING

EE Cell ID: 53130	MBNL Cell ID: CHD001	3UK Cell ID: LE0211
-------------------	----------------------	---------------------

Master Drawing No: 981717_CHD001_53130_LE0211_M001	Issue: B
--	----------

100mm
50mm
10mm