

EXISTING LOCATION PLAN 1:1250

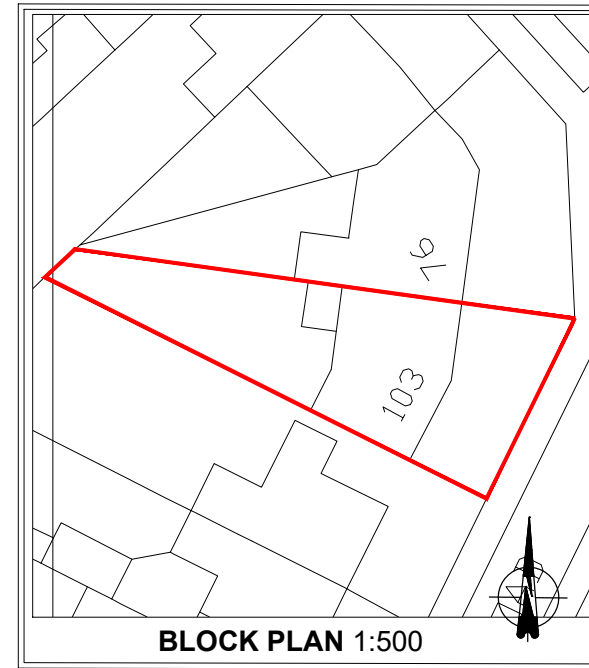

BLOCK PLAN 1:500

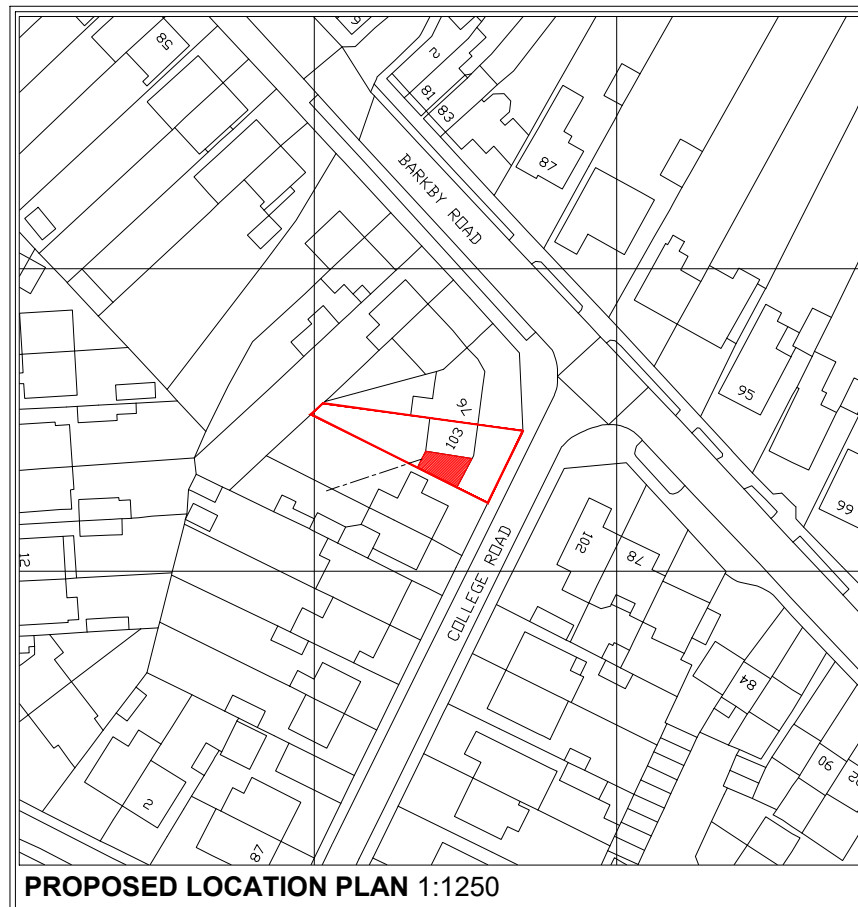

PROPOSED LOCATION PLAN 1:1250

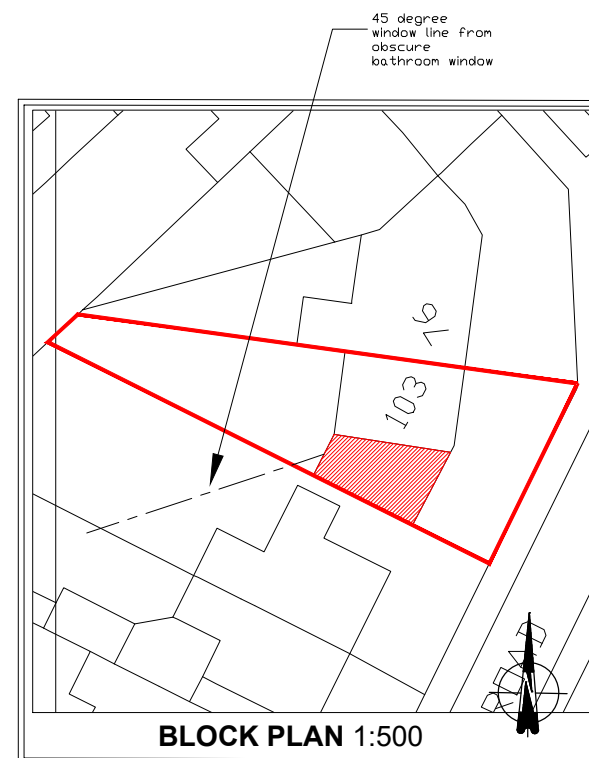

BLOCK PLAN 1:500

REVISION A- PRELIMINARY ISSUE
SITE LOCATION

CLIENT: Rachel Woodward	
JOB DESCRIPTION: PROPOSED SIDE EXTENSION TO 103 COLLEGE ROAD, SYSTON, LE7 2AQ	
SCALE 1:100 @ A3	DATE 30.07.21
DRAWN BY JTC	DRAWING No: 003

ALL DIMENSIONS TO BE CHECKED ON SITE BEFORE CONSTRUCTION.
 ANY DISCREPANCIES TO BE DISCUSSED AND AGREED WITH ARCHITECTURAL TECH PRIOR TO PROCEEDING.
 THIS DRAWING IS THE PROPERTY OF DRAWER AND MUST NOT BE COPIED OR REPRODUCED WITHOUT PRIOR WRITTEN CONSENT.
 HEALTH AND SAFETY EXECUTIVE (HSE) WILL NEED TO BE NOTIFIED PRIOR TO COMMENCEMENT OF THE PROJECT